

URBAN RESIDENCES



The Residences at Person's Corner offers contemporary living over Raleigh's newest retail location. Choose from 11 unique floor plans ranging from a 722 sq. ft. one-bedroom flat to a 1943 sq. ft. three-bedroom residence. Enjoy balcony living, interior courtyard space, secured parking and modern features such as stainless steel appliances, granite countertops and hardwood flooring in your new urban residence.

URBAN RESIDENCES THE LAYOUT



LEVEL FOUR

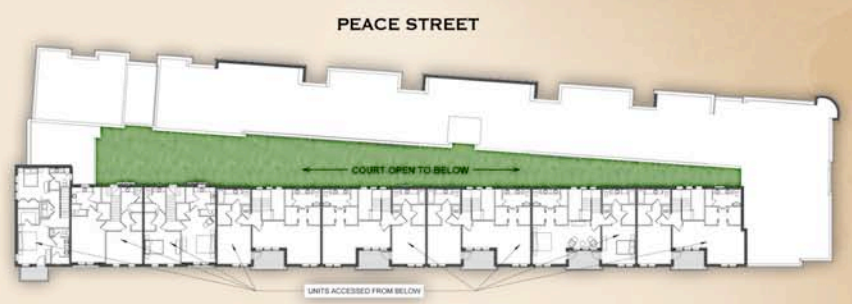

LEVEL FIVE



LEVEL TWO

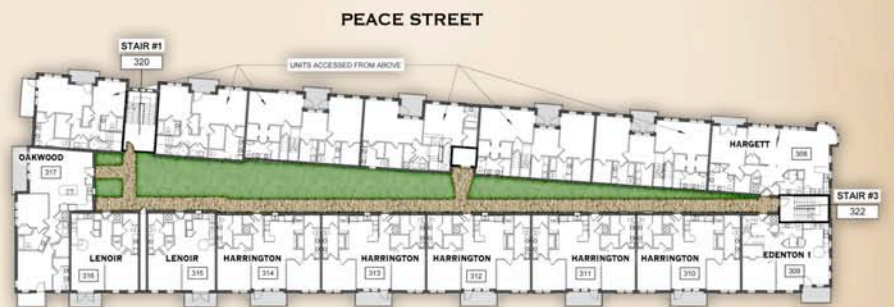

LEVEL THREE

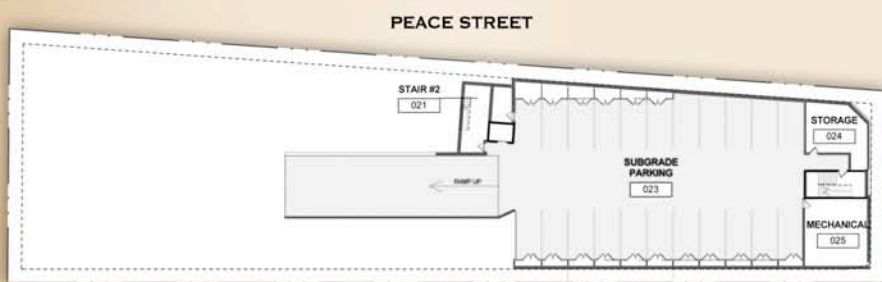

SUBLEVEL - PARKING



LEVEL ONE